

# PIKCELL GROUP

## MONO MODULE

### PIK 410 - 415M(144)

Best in class quality PiKCELL Group production line is fully automated and include multiple quality checks throughout the production process including Cell Testing, 100% Visual Mirror Inspection, EL Testing and PV Sun Simulator Testing



High conversion efficiency  
High module efficiency to guarantee power output.



Excellent loading capability  
2400Pa wind loads, 5400Pa snow loads.

0 to +5W

0 to +5W positive tolerance  
Detailed information in Electrical Specifications



Self-cleaning glass  
Coating glass for self-cleaning, reduce surface dust.



Outstanding low irradiation performance  
Excellent module efficiency even in the weak light conditions, such as morning or cloudy.

48

48-hour responsive service

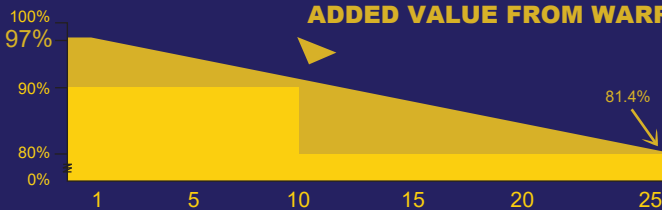

10

10-year warranty on materials and workmanship

25

25-year performance warranty

Bldv. Partizanski Odredi 40-1/5  
1000 Skopje

Tel: +389(2) 3109 077

Fax: +389(2) 3256 588

www.pikcellgroup.mk

E-mail: contact@pikcellgroup.mk



ProCredit Bank AD Skopje  
Account No. 380176950607221  
IBAN: MK07

SWIFT: PRBUMK22XXX  
Komerijalna Banka AD Skopje

Account No. 0270100238818  
IBAN: MK07300701002388107

SWIFT: KOBSMK2X



EN ISO 9001 : 2015  
No 4410021320170  
EN ISO 14001 : 2015  
No 4410421320170  
EN ISO 45001 : 2018  
No 4412621320170

## ELECTRICAL DATA

Model Type	PiK410M	PiK415M
Peak Power (Pmax)/W	410	415
Module Efficiency/%	20.4	20.7
Maximum Power Voltage (Vmp)/V	40.65	40.70
Maximum Power Current (Imp)/A	10.10	10.20
Open Circuit Voltage (Voc)/V	48.90	49.00
Short Circuit Voltage (Isc)/A	10.70	10.80
Power Tolerance	0 to +5W	
Maximum System Voltage	1500V	
Nominal Operating Cell Temperature	44.4±2°C	
Maximum Series Fuse Rating	20A	

## MECHANICAL DATA

Cell Type	Monocrystalline
Number of Cells	144 cells (6x12x2)
Weight	23kg
Dimensions	2015x996x35mm
Max Load	5400 Pascals
Junction Box	IP68 rated
Connector	Twinsel PV-SY02, IP68
Wire Type	Compatible PV Wire

## TEMPERATURE CHARACTERISTICS

Temp. Coeff. of Isc (TK Isc)	0.04% /°C
Temp. Coeff. of Voc (TK Voc)	-0.28% /°C
Temp. Coeff. of Pmax (TK Pmax)	-0.37% /°C

## PACKING MANNER

Container	40' HQ
Pieces per Pallet	31
Pieces per Container	759

## ELECTRICAL CHARACTERISTICS

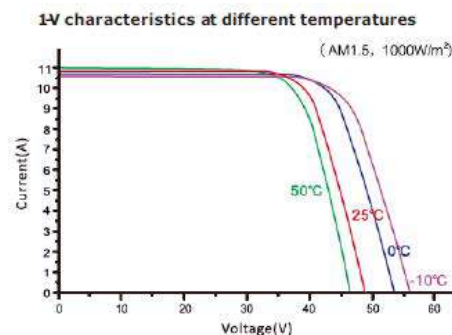
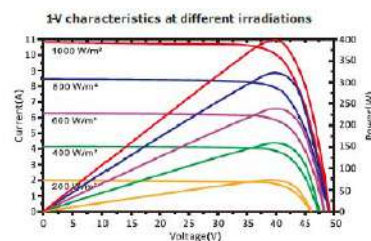

## PHYSICAL CHARACTERISTICS

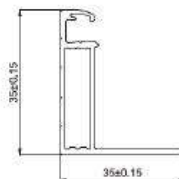
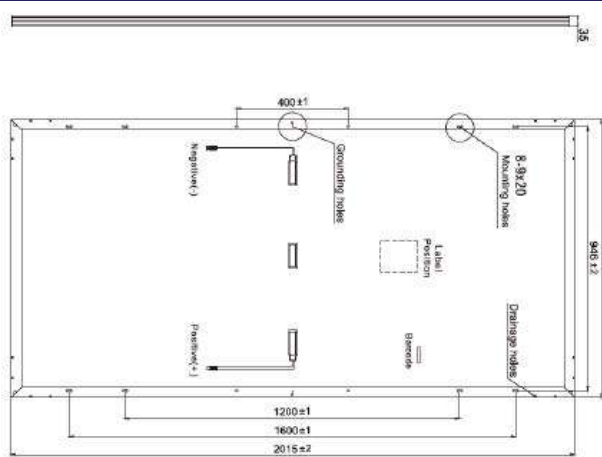

Note: the specifications are obtained under the Standard Test Conditions (STCs): 1000W/m<sup>2</sup> solar irradiance, 1.5 Air Mass, and cell temperature of 25°C. The NOCT is obtained under the Test Conditions: 800W/m<sup>2</sup>, 20°C ambient temperature, 1m/s wind speed, AM 1.5 spectrum. Please contact [contact@pikcellgroup.mk](mailto:contact@pikcellgroup.mk) for technical support. The actual transactions will be subject to the contracts. These parameters are for reference only and it is not a part of the contracts. The specifications are subject to change without prior notice.