

PIKCELL GROUP

MONO MODULE

PIK - 425

Best in class quality PiKCELL Group production line is fully automated and include multiple quality checks throughout the production process including Cell Testing, 100% Visual Mirror Inspection, EL Testing and PV Sun Simulator Testing



High conversion efficiency
High module efficiency to guarantee power output.



Excellent loading capability
2400Pa wind loads, 5400Pa snow loads.

0 to +5W

0 to +5W positive tolerance
Detailed information in Electrical Specifications



Self-cleaning glass
Coating glass for self-cleaning, reduce surface dust.



Outstanding low irradiation performance
Excellent module efficiency even in the weak light conditions, such as morning or cloudy.

48

48-hour responsive service

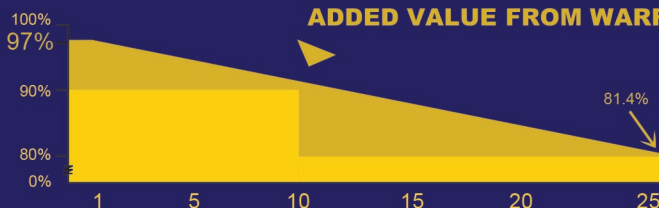

Standard tiered warranty

Linear performance warranty

12

12-year warranty on materials and workmanship

25

25-year performance warranty

Bldv. Partizanski Odredi 40-1/5

1000 Skopje

Tel: +389(2) 3109 077

Fax: +389(2) 3256 588

www.pikcellgroup.mk

E-mail: contact@pikcellgroup.mk



ProCredit Bank AD Skopje
Account No. 380176950607221

IBAN: MK07

SWIFT: PRBUMK22XXX

Komercijalna Banka AD Skopje

Account No. 0270100238818

IBAN: MK07300701002388107

SWIFT: KOBSMK2X



EN ISO 9001 : 2015
No 4410021320170
EN ISO 14001 : 2015
No 4410421320170
EN ISO 45001 : 2018
No 4412621320170

ELECTRICAL DATA

Model Type	PiK 425
Peak Power (Pmax)/W	425
Module Efficiency/%	21.2
Maximum Power Voltage (Vmp)/V	40.90
Maximum Power Current (Imp)/A	10.40
Open Circuit Voltage (Voc)/A	49.20
Short Circuit Voltage (Isc)/A	11.00
Power Tolerance	0 to +5W
Maximum System Voltage	1500V
Nominal Operating Cell Temperature	44.4±2°C
Maximum Series Fuse Rating	15A

MECHANICAL DATA

Cell Type	Monocrystalline, 9BB
Number of Cells	144 cells (6x12+6x12)
Weight	23kg
Dimension	2015x996x35mm
Max Load	5400 Pascals
Junction Box	IP68 rated
Connector	Twinsel PV-SY02, IP68
Wire Type	Compatible PV Wire

TEMPERATURE CHARACTERISTICS

Temp. Coeff of Isc (TK Isc)	0.04%/°C
Temp. Coeff of Voc (TK Voc)	-0.28%/°C
Temp. Coeff of Pmax (TK Pmax)	-0.37%/°C

PHYSICAL CHARACTERISTICS

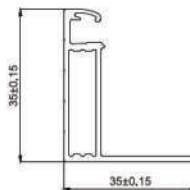
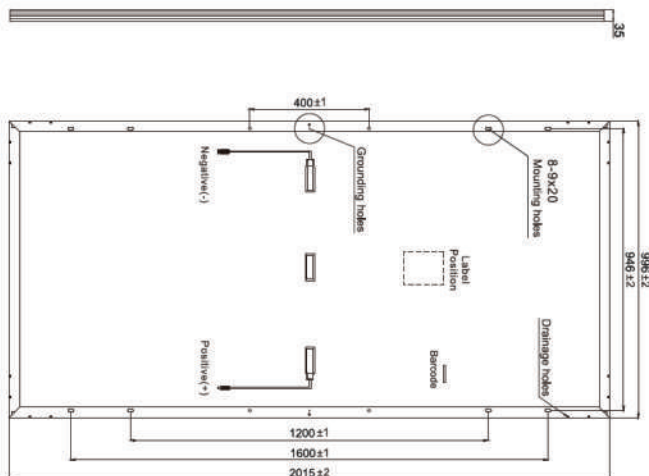

ELECTRICAL CHARACTERISTICS

1-V characteristics at different irradiances

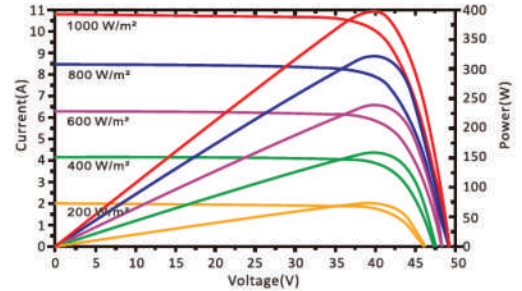

1-V characteristics at different temperatures

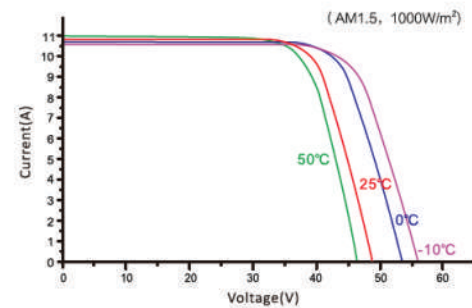

Note: the specifications are obtained under the Standard Test Conditions (STCs): 1000W/m² solar irradiance, 1.5 Air Mass, and cell temperature of 25°C. The NOCT is obtained under the Test Conditions: 800W/m², 20°C ambient temperature, 1m/s wind speed, AM 1.5 spectrum.

Please contact contact@pikcellgroup.mk for technical support. The actual transactions will be subject to the contracts. These parameters are for reference only and it is not a part of the contracts. The specifications are subject to change without prior notice.